

CREP MAKER

CONTENTS

A	GENERAL INFORMATION	Page 2
A1	PRODUCT DESCRIPTION	Page 3
A2	TECHNICAL INFORMATION.....	Page 3
A3	TRANSPORTATION.....	Page 4
A4	UNPACKING	Page 4
B	INSTALLATION	Page 4
C	SAFETY INSTRUCTIONS.....	Page 5
D	OPERATION	Page 6
E	CLEANING & MAINTENANCE.....	Page 7
F	TROUBLESHOOTING.....	Page 8
G	SPARE PART LIST- EXPLODING DRAWING	Page 9
H	ELECTRIC CIRCUIT SCHEMA	Page 13

A GENERAL INFORMATION

Before installing the appliance, read operation and maintenance instructions carefully. Wrong installation and part changing may damage the product or may cause injury on people. These are not in our company's responsibility to damage the appliance intentionally, negligence, detriments because of disobeying instructions and regulations, wrong connections. Unauthorized intervention to appliance invalidates the warranty.

1. This instruction manual should be kept in a safe place for future reference.
- 2. Installation should be made in accordance with ordinances and security rules of that country by a qualified service personnel.**
3. This appliance has to be used by trained person.
4. Please turn off the appliance immediately in the event of malfunction or failure. The appliance should be repaired only by authorized service personnel. Please demand original spare part.

CREP MAKER

A1 PRODUCT DESCRIPTION

*The Professional Waffel Maker ,that provides high efficiency has been designed to be used in industrial kitchens.

Product Code	Dimensions (mm)	Weight (kg)	Packaging Dimensions (mm)
EMP.KR.010	450x520x240	19	500x560x280
EMP.KR.020	900x520x240	37	960x560x280

A2 TECHNICAL INFORMATION

Product Code	Capacity (cm)	Model	Power (KW)	Operating Voltage (V)	Cable (mm ²)	Fuse (A)
EMP.KR.010	2x8x16x1,5	Single	3	220-230	3x1,5	10
EMP.KR.020	2x(4x8x16x1,5)	Double	2x3	220-230	3x1,5	16

A3 TRANSPORTATION

*This appliance can be moved by hand from area to area. Do not crash and drop the appliance while transporting.

A4 UNPACKING

*Please unpack the package according to the security codes and ordinances of current country and get rid from the pack. Parts which contacts with food are produced by stainless steel. All plastic parts are marked by material's symbol.

*Please check that all the parts of appliance had come completely and if they are damaged or not during the shipping.

B INSTALLATION

*Please place the product to straight and sturdy ground, please take necessary steps against possibility of overturn.

*Technician who will serve for installation and service for the appliance must be professional on this subject and must have installation and service licenses by the company.

*Connection to Electric Power Supply must be done by authorized person.

*Please be sure that the voltage connected to appliance must be equal with the voltage which is on appliance's label.











This appliance must be connected to an earthed outlet in accordance with safety rules and standards.

*Appliance's earthing must be connected to earthing line on panel which is nearest to electric installation.

*Connection to the main fuse and leak current fuse must be done in accordance with the current regulations.

CREP MAKER

C SAFETY INSTRUCTIONS

-  *Do not use the appliance in insufficient lighted place.
-  *Do not touch the moving attachments while the appliance operates.
-  *Do not install the appliance in the presence of flammable or explosive materials.
-  *Do not operate the appliance when the machine is empty.
-  *Do not load so less or more than appliance's capacity .
-  *Do not attempt to use the appliance without suitable protective equipments.
-  *Because of any reason if there is a fire or flame flare where the appliance is used,turn off all gas valves and electric contactor switch quickly and use fire extinguisher .Never use water to extinguish the fire.
-  *All the damages because of not having earthing connection will not be on warranty.
-  *Do not place the appliance on carpet,table cloth etc. that can be burnt easily.

D OPERATION

*Control Panel;

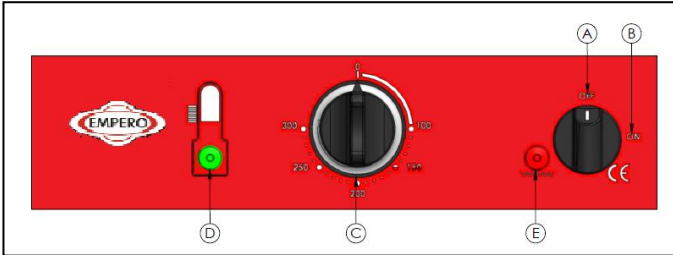

- A : OFF position
- B : ON position
- C : Thermostat
- D : Indicator lamp
- E : Signal lamp

*Operating;

- Before operating the appliance, clean the cooking surface of the crep maker with a cloth that is sunken to liquid oil for food.
- Plug in the appliance and switch ON.
- Operate the appliance around 180°C - 200°C for 1 hour during first use.
- Heat the crep maker at the hottest temperature (300°C).After 15 min. Adjust the heat to desired temperature.
- After adjusting the desired heat,the heat control lamp that is green signals.It means that the appliance is getting heated.
- When the temperature reaches to desired temperature,the heat control lamp is off.When the temperature of the appliance reduces,the heat control lamp signals again and the appliance goes on heating till reaching desired temperature.
- Put crep dough on the cooking surface and spread equally.
- Pay attention the crep dough not to be so much.Otherwise the crep dough may drop from surface.
- In order to spread the dough to the surface smoothly,keep the distribution attachment always in water.
- In order to turn the crepe,use crepe turning spatula.
- When the operation is completed,switch the thermostat to (0) position and switch OFF or unplug the appliance.

CREP MAKER

E CLEANING & MAINTENANCE

➤ **CLEANING AND MAINTENANCE AFTER EVERY USE**

- Clean the cooking surface with dry paper towel or soft moist cloth. Check if water or solid oil leaks to the appliance.
- Always turn off the appliance and disconnect from the power supply before cleaning.
- Wash the crepe attachments often with hot water and detergent.
- Do not use abrasive cleaning chemicals as these can leave harmful residues.
- Do not clean the appliance by spraying water directly, otherwise electric motor may get damaged.

➤ **PERIODIC CLEANING AND MAINTENANCE**

- Maintenance should be done by qualified person.
- Get the periodic maintenance of the appliance once in every 15 days.
- Check that if the power cable has error or not. If there is error at the cable, definitely do not use the appliance. Provide the cable to be changed by authorized technic service.

F TROUBLESHOOTING

THE APPLIANCE DOESN'T OPERATE	<ol style="list-style-type: none">1. Check if the appliance is plugged in.2. Check the electrical connections and voltage.
THE APPLIANCE STOPPED	<ol style="list-style-type: none">1. The appliance can stop due to low voltage. In this situation check the voltage.
THE APPLIANCE IS NOT HEATED	<ol style="list-style-type: none">1. Check the resistances.2. Check the thermostat buttons.
<ul style="list-style-type: none">• If the crepe making is not done at suitable quality• If any function of security doesn't work<ul style="list-style-type: none">➤ Do not use the appliance.	

***If these problems are still going on, contact with our authorized services.**

CREP MAKER

G SPARE PART LIST-EXPLODING DRAWING

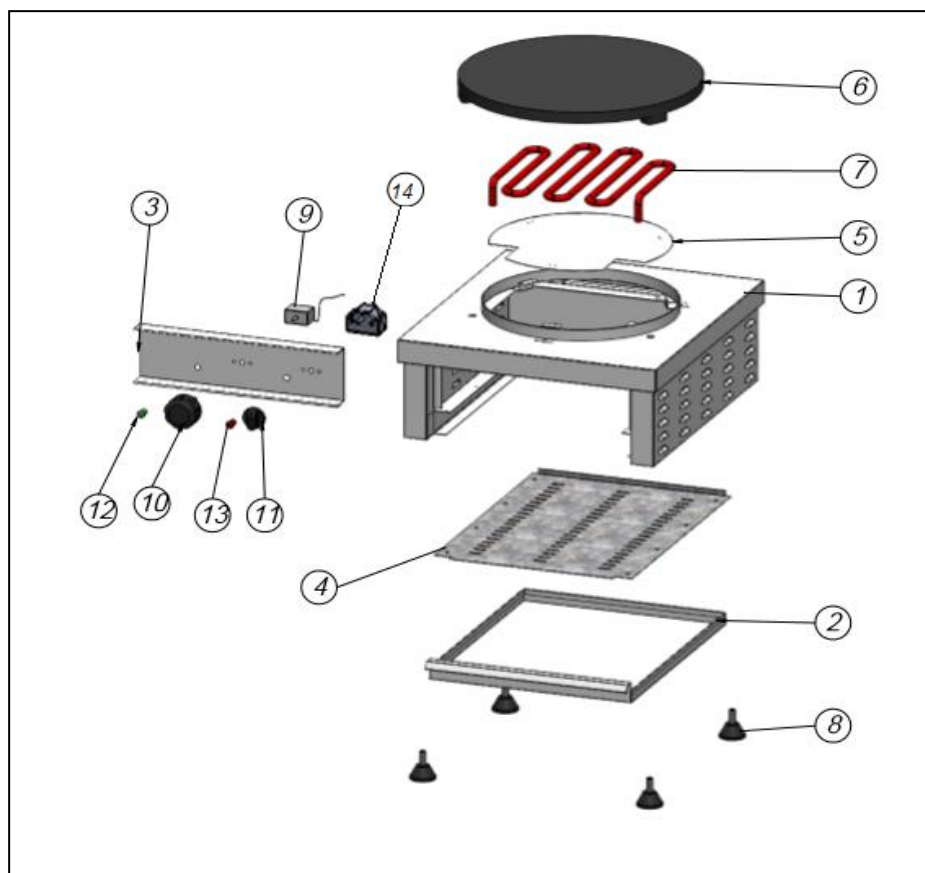

EMP.KR.010

G SPARE PART LIST-EXPLODING DRAWING

PRODUCT CODE:EMP.KR.010		
NO	PRODUCT NAME	P.CODE
1	BASE FRAME	Y.EMP.KR.010.001
2	DRAWER	Y.EMP.KR.010.002
3	CONTROL PANEL	Y.EMP.KR.010.003
4	AIR CONDITIONING SHEET METAL	Y.EMP.KR.010.004
5	RESISTANCE HOLDER	Y.EMP.KR.010.005
6	CASTING PLATE	Y.EMP.KR.010.006
7	RESISTANCE	Y.EMP.KR.010.007
8	FEET	Y.EMP.KR.010.008
9	THERMOSTAT	Y.EMP.KR.010.009
10	THERMOSTAT BUTTON	Y.EMP.KR.010.010
11	SWITCH BUTTON	Y.EMP.KR.010.011
12	THERMOSTAT LED	Y.EMP.KR.010.012
13	SWITCH LED	Y.EMP.KR.010.013
14	SWITCH	Y.EMP.KR.010.014

CREP MAKER

G SPARE PART LIST-EXPLODING DRAWING

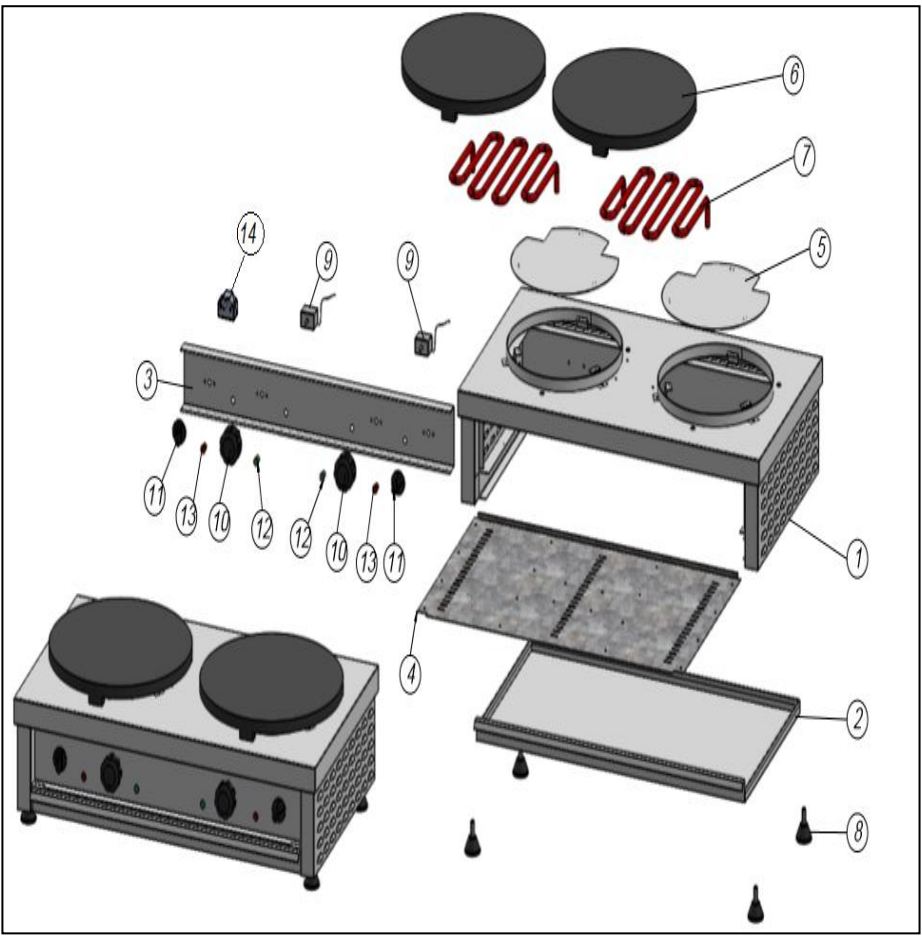

EMP.KR.020

G SPARE PART LIST-EXPLODING DRAWING

PRODUCT CODE:EMP.KR.020		
NO	PRODUCT NAME	P.CODE
1	BASE FRAME	Y.EMP.KR.020.001
2	DRAWER	Y.EMP.KR.020.002
3	CONTROL PANEL	Y.EMP.KR.020.003
4	AIR CONDITIONING SHEET METAL	Y.EMP.KR.020.004
5	RESISTANCE HOLDER	Y.EMP.KR.020.005
6	CASTING PLATE	Y.EMP.KR.020.006
7	RESISTANCE	Y.EMP.KR.020.007
8	FEET	Y.EMP.KR.020.008
9	THERMOSTAT	Y.EMP.KR.020.009
10	THERMOSTAT BUTTON	Y.EMP.KR.020.010
11	SWITCH BUTTON	Y.EMP.KR.020.011
12	THERMOSTAT LED	Y.EMP.KR.020.012
13	SWITCH LED	Y.EMP.KR.020.013
14	SWITCH	Y.EMP.KR.020.014

CREP MAKER

H ELECTRIC CIRCUIT SCHEMA

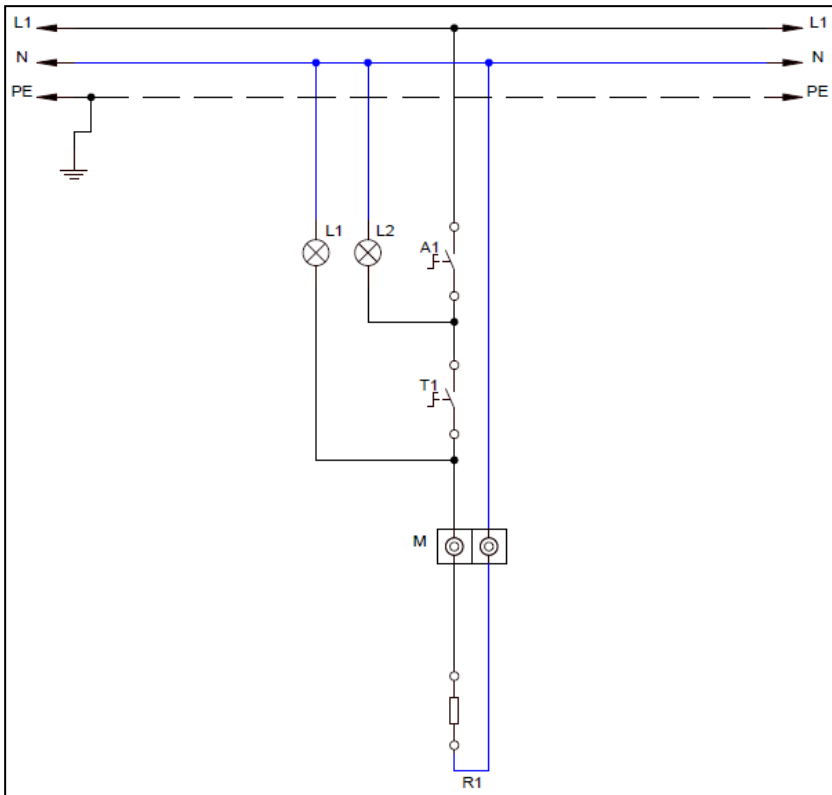

EMP.KR.010

L2	A1	T1	R1	M	L1
Key Open Lamp	ON/OFF switch	Thermostat (100-300°)	Resistance 2200 W	Ceramic Terminal Block	Thermostat Open Lamp

H ELECTRIC CIRCUIT SCHEMA

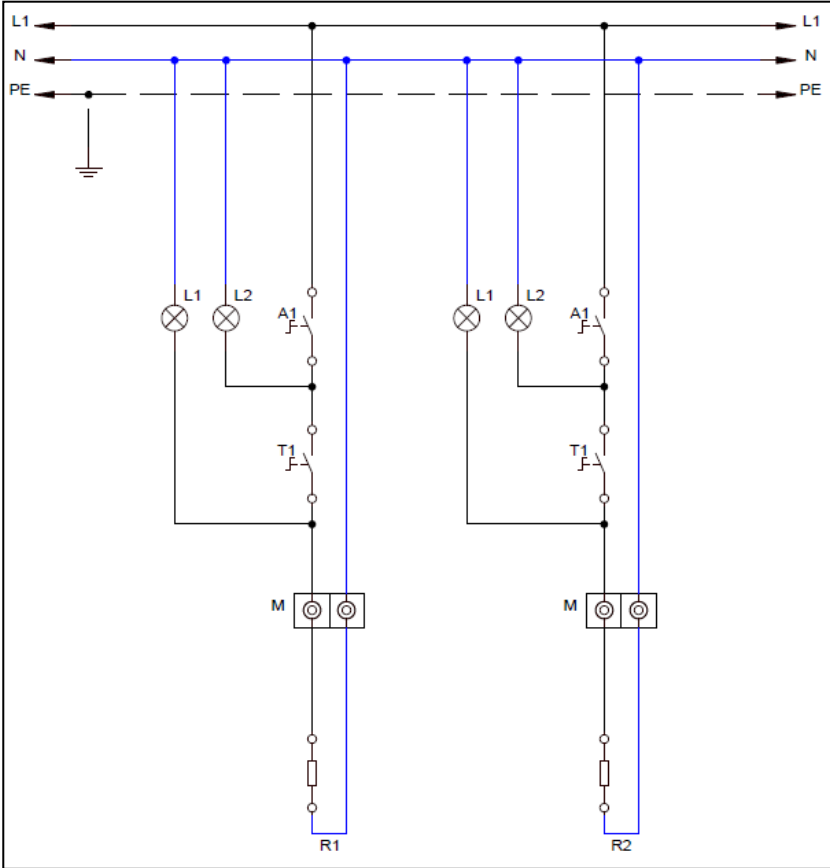

EMP.KR.020

L2	M	A1	T1	R1.R2	L1
Key Open Lamp	Ceramic Terminal Block	ON/OFF switch	Thermostat (100-300°)	Resistance 2200 W	Thermostat Open Lamp