

# CONVEYOR TOASTER

## CONTENTS

---

<b>A</b>	<b>GENERAL INFORMATION .....</b>	<b>Page 2</b>
A1	PRODUCT DESCRIPTION.....	Page 3
A2	TECHNICAL INFORMATION .....	Page 3
A3	TRANSPORTATION .....	Page 4
A4	UNPACKING .....	Page 4
<b>B</b>	<b>INSTALLATION .....</b>	<b>Page 4</b>
<b>C</b>	<b>SAFETY INSTRUCTIONS .....</b>	<b>Page 5</b>
<b>D</b>	<b>OPERATION .....</b>	<b>Page 6</b>
<b>E</b>	<b>CLEANING &amp; MAINTENANCE .....</b>	<b>Page 7</b>
<b>F</b>	<b>TROUBLESHOOTING .....</b>	<b>Page 8</b>
<b>G</b>	<b>SPARE PART LIST- EXPLODING DRAWING .....</b>	<b>Page 9</b>
<b>H</b>	<b>ELECTRIC CIRCUIT SCHEMA .....</b>	<b>Page 11</b>

## A GENERAL INFORMATION

---

**Before installing the appliance, read operation and maintenance instructions carefully. Wrong installation and part changing may damage the product or may cause injury on people. These are not in our company's responsibility to damage the appliance intentionally, negligence, detriments because of disobeying instructions and regulations, wrong connections. Unauthorized intervention to appliance invalidates the warranty.**

1. This instruction manual should be kept in a safe place for future reference.
- 2. Installation should be made in accordance with ordinances and security rules of that country by a qualified service personnel.**
3. This appliance has to be used by trained person.
4. Please turn off the appliance immediately in the event of malfunction or failure. The appliance should be repaired only by authorized service personnel. Please demand original spare part.

# CONVEYOR TOASTER

## A1 PRODUCT DESCRIPTION

---

\*The Professional Conveyor Toaster ,that provides high efficiency has been designed to be used in industrial kitchens.

Product Code	Dimensions (mm)	Weight (kg)	Packaging Dimensions (mm)
EMP.MEK010	478x600x420	35	540x560x430

## A2 TECHNICAL INFORMATION

---

Product Code	Electric Inlet	Cable (mm <sup>2</sup> )	Power (KW)	Capacity (slice/h)
EMP.MEK010	230 V. AC N PE	3x2,5	3,5	600

### **A3 TRANSPORTATION**

---

\*This appliance can be moved by hand from area to area. Do not crash and drop the appliance while transporting.

### **A4 UNPACKING**

---

\*Please unpack the package according to the security codes and ordinances of current country and get rid from the pack. Parts which contacts with food are produced by stainless steel. All plastic parts are marked by material's symbol.

\*Please check that all the parts of appliance had come completely and if they are damaged or not during the shipping.

### **B INSTALLATION**

---

\*Please place the product to straight and sturdy ground, please take necessary steps against possibility of overturn.

\*Technician who will serve for installation and service for the appliance must be professional on this subject and must have installation and service licenses by the company.

\*Connection to Electric Power Supply must be done by authorized person.

\*Please be sure that the voltage connected to appliance must be equal with the voltage which is on appliance's label.

 This appliance must be connected to an earthed outlet in accordance with safety rules and standards.

\*Appliance's earthing must be connected to earthing line on panel which is nearest to electric installation.









\*Connection to the main fuse and leak current fuse must be done in accordance with the current regulations.

\*If the location where Conveyor Toaster placed is covered with nonflammable heat insulation material, the distance between them must be 5 cm. Otherwise it should be at least 20 cm. The appliance shouldn't be operated under chimney hood.

# CONVEYOR TOASTER

## C SAFETY INSTRUCTIONS

---

-  \*Do not use the appliance in insufficient lighted place.
-  \*Do not touch the moving attachments while the appliance operates.
-  \*Do not install the appliance in the presence of flammable or explosive materials.
-  \*Do not operate the appliance when the machine is empty.
-  \*Do not load so less or more than appliance's capacity.
-  \*Do not attempt to use the appliance without suitable protective equipments.
-  \*Because of any reason if there is a fire or flame flare where the appliance is used, turn off all gas valves and electric contactor switch quickly and use fire extinguisher. Never use water to extinguish the fire.
-  \*All the damages because of not having earthing connection will not be on warranty.

## D OPERATION

---

### \*Control Panel;

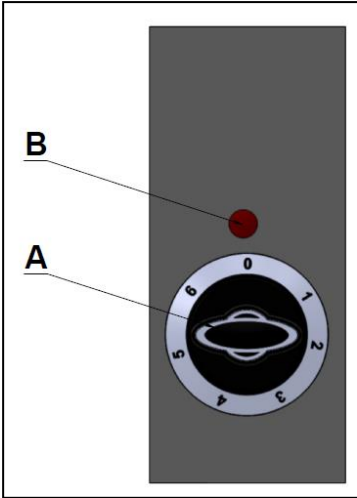

A : Heat setting button

B : Indicator lamp

### \*Operating;

- Plug in the appliance.
- In order to operate the appliance switch (1-6) to desired temperature.
- The pallette will move to operate the heaters.
- The lamp on switch will be on while the appliance is operating.
- The appliance will start to toast 5 minutes later after being operated.
- Put the breads that are sliced at standard thickness on the palet.
- After the operation is completed,switch the thermostat to (0) position and unplug the appliance.

# CONVEYOR TOASTER

## **E      CLEANING & MAINTENANCE**

---

### ➤ **CLEANING AND MAINTENANCE AFTER EVERY USE**

- Always turn off the appliance and disconnect from the power supply before cleaning.
- Clean the outer surface of the appliance with a wet cloth and chrome shiner.
- Do not use abrasive cleaning chemicals as these can leave harmful residues.
- Do not clean the appliance by spraying water directly, otherwise electric motor may get damaged.

### ➤ **PERIODIC CLEANING AND MAINTENANCE**

- Maintenance should be done by qualified person.
- Get the periodic maintenance of the appliance once in every 15 days.
- Clean the palet and grill according to frequency of use and do not allow the residues to be accumulated.

**F TROUBLESHOOTING**

<b>THE APPLIANCE DOESN'T OPERATE</b>	<ol style="list-style-type: none"><li>1. Check if the appliance is plugged in.</li><li>2. Check the electrical connections and voltage.</li><li>3. Check the fuse if it is on or not.</li></ol>
--------------------------------------	---

<b>THE APPLIANCE DOESN'T COOK WELL</b>	<ol style="list-style-type: none"><li>1. Check the switch temperature is set to desired temperature or not.</li><li>2. Check if the suitable positions are chosen or not for moist and dry slices of breads.</li><li>3. Before frying moist slices of breads, place them on the grill.</li></ol>
--	--

<b>THE APPLIANCE STOPPED</b>	<ol style="list-style-type: none"><li>1. The appliance can stop due to low voltage. In this situation check the voltage.</li></ol>
------------------------------	--

- If bread frying is not done at suitable quality
- If any function of security doesn't work
  - Do not use the appliance.

**\*If these problems are still going on, contact with our authorized services.**



# CONVEYOR TOASTER

## G SPARE PART LIST-EXPLODING DRAWING

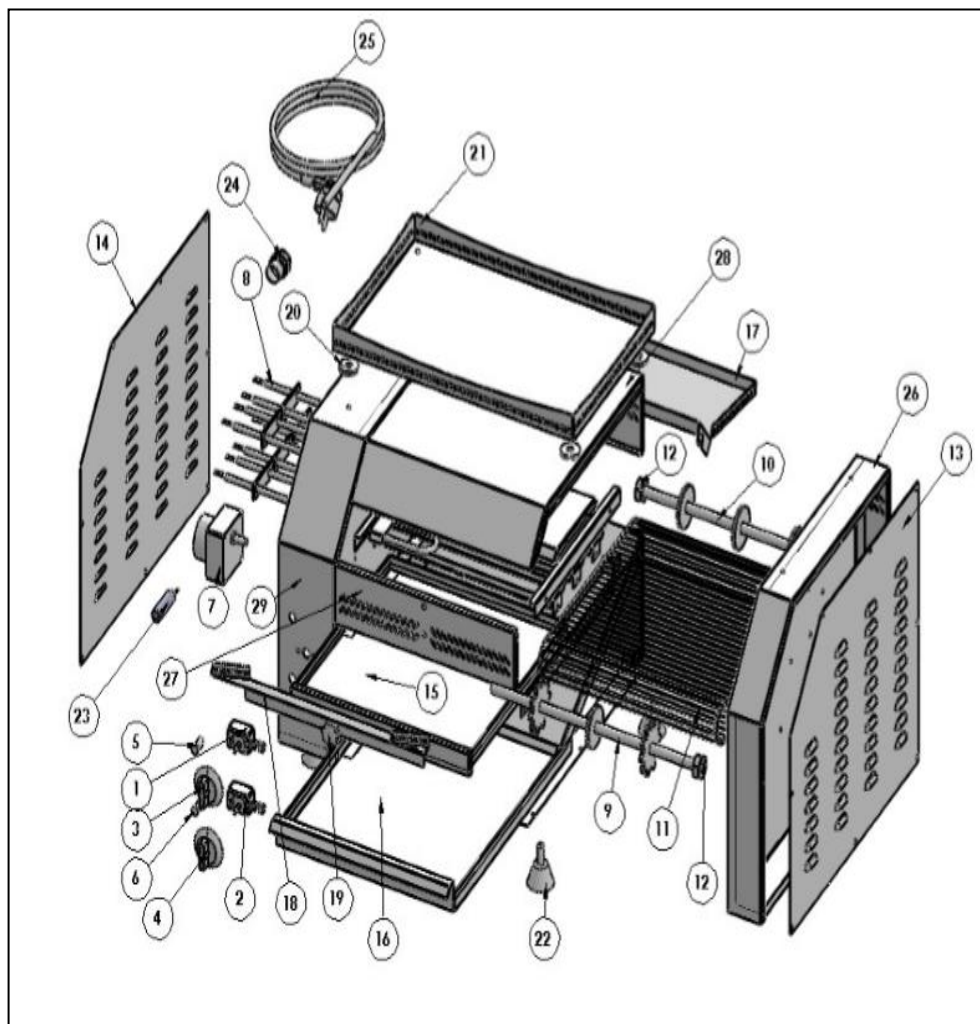

**G SPARE PART LIST-EXPLODING DRAWING**

<b>PRODUCT CODE: EMP.MEK010</b>		
<b>NO</b>	<b>PRODUCT NAME</b>	<b>P.CODE</b>
1	ON-OFF SWITCH	Y.EMP.MEK010.001
2	SWITCH	Y.EMP.MEK010.002
3	ON-OFF BUTTON	Y.EMP.MEK010.003
4	SWITCH BUTTON	Y.EMP.MEK010.004
5	ON-OFF LAMP (RED)	Y.EMP.MEK010.005
6	SWITCH LAMP (GREEN)	Y.EMP.MEK010.006
7	MOTOR	Y.EMP.MEK010.007
8	RESISTANCE	Y.EMP.MEK010.008
9	CONVEYOR FRONT GEAR	Y.EMP.MEK010.009
10	CONVEYOR BACK GEAR	Y.EMP.MEK010.010
11	CONVEYOR WIRE	Y.EMP.MEK010.011
12	MOVEMENT NUT (SHAFT)	Y.EMP.MEK010.012
13	SIDE LID (RIGHT)	Y.EMP.MEK010.013
14	SIDE LID (LEFT)	Y.EMP.MEK010.014
15	CRUMB TRAY	Y.EMP.MEK010.015
16	BREAD TRAY	Y.EMP.MEK010.016
17	BREAD TRAY (BACK)	Y.EMP.MEK010.017
18	BREAD SLEDGE	Y.EMP.MEK010.018
19	SLEDGE FIXED	Y.EMP.MEK010.019
20	BREAD BIN FIXED	Y.EMP.MEK010.020
21	BREAD BIN	Y.EMP.MEK010.021
22	FEET	Y.EMP.MEK010.022
23	CONDENSATOR	Y.EMP.MEK010.023
24	SLEEVE	Y.EMP.MEK010.024
25	SUPPLY CABLE	Y.EMP.MEK010.025
26	SIDE RIGHT PANEL (OUTER)	Y.EMP.MEK010.026
27	FRONT PANEL (OUTER)	Y.EMP.MEK010.027
28	TOP LID	Y.EMP.MEK010.028
29	SIDE LEFT PANEL (OUTER)	Y.EMP.MEK010.029

# CONVEYOR TOASTER

## H ELECTRIC CIRCUIT SCHEMA

208V 1 PHASE

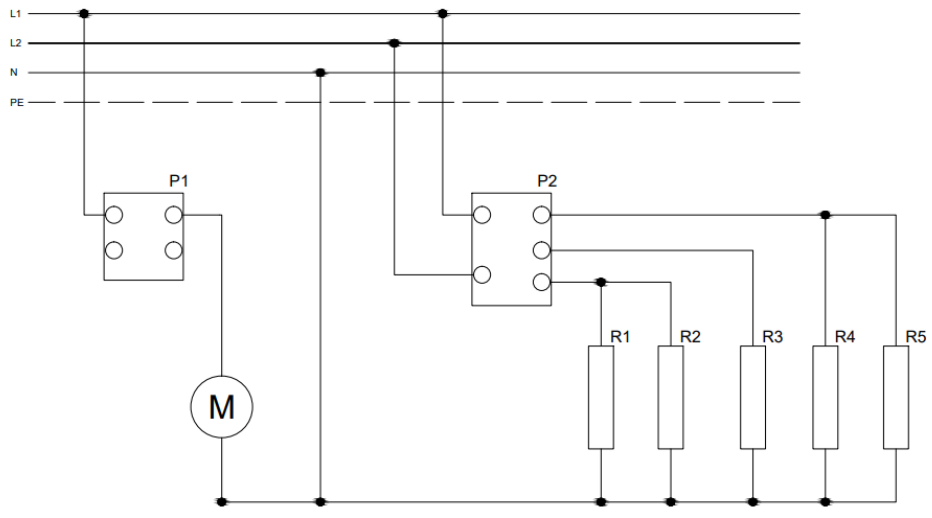

P1 - 0/1 SWITCH  
R1/R2/R3/R4/R5 - RESISTANCE  
P2 - 0/1/2/3 SWITCH  
M - MOTOR