

ELECTRICAL CHICKEN ROTISSERIE

CONTENTS

A	GENEERAL INFORMATION.....	Page 2
A1	PRODUCT DESCRIPTION	Page 3
A2	TECHNICAL INFORMATION	Page 3
A3	TRANSPORTATION	Page 3
A4	UNPACKING	Page 3
B	INSTALLATION	Page 4
C	SAFETY INSTRUCTIONS	Page 5
D	OPERATION	Page 6
E	CLEANING & MAINTENANCE.....	Page 7
F	TROUBLESHOOTING	Page 8
G	DEVICE VIEWS	Page 8
H	SPARE PART LIST- EXPLODING DRAWINGS	Page 9
I	ELECTRICAL CIRCUIT DIAGRAM.....	Sayfa 17

A GENERAL INFORMATION

Before installing the appliance, read operation and maintenance instructions carefully. Wrong installation and part changing may damage the product or may cause injury on people. These are not in our company's responsibility to damage the appliance intentionally, negligence, detriments because of disobeying instructions and regulations, wrong connections. Unauthorized intervention to appliance invalidates the warranty.

1. This instruction manual should be kept in a safe place for future reference.
2. Installation should be made in accordance with ordinances and security rules of that country by a qualified service personnel.
3. This appliance has to be used by trained person.
4. Please turn off the appliance immediately in the event of malfunction or failure. The appliance should be repaired only by authorized service personnel. Please demand original spare part.

ELECTRICAL CHICKEN ROTISSERIE

A1 PRODUCT DESCRIPTION

*The Professional Electrical chicken rotisserie ,that provides high efficiency has been designed to be used in industrial kitchen.

Product Code	Dimensions (mm)	Weight (kg)
EMP.3EE	1194x481x820	108
EMP.5EE	1194x481x1180	144
EMP.PLS.5EE	1194x565x2030	193
EMP.8EE	1194x481x2030	214

A2 TECHNICAL INFORMATION

Code	Capacity (Pieces)	Power (KW)	Operating Voltage (V)	Frequency (Hz)
EMP.3EE	18	9,9	220/380	50
EMP.5EE	30	16,5	220/380	50
EMP.PLS.5EE	30	16,5	220/380	50
EMP.8EE	48	26,4	220/380	50

A3 TRANSPORTATION

*This appliance can not be moved by hand from area to area.It must be moved on pallet with forklift truck.

A4 UNPACKING

*Please unpack the package according to the security codes and ordinances of current country and get rid from the pack.Parts which contacts with food are produced by stainless steel.All plastic parts are marked by material's symbol.

*Please check that all the parts of appliance had come completely and if they are damaged or not during the shipping.

B INSTALLATION

*Please place the product to straight and sturdy ground, please take necessary steps against possibility of overturn.

*Technician who will serve for installation and service for the appliance must be professional on this subject and must have installation and service licenses by the company.

*Connection to Electric Power Supply must be done by authorized person.

*Please be sure that the voltage connected to appliance must be equal with the voltage which is on appliance's label.



This appliance must be connected to an earthed outlet in accordance with safety rules and standard.

*Appliance's earthing must be connected to earthing line on panel which is nearest to electric installation.

*Connection to the main fuse and leak current fuse must be done in accordance with the current regulations.

*The rotisserie is equipped with at least one infrared burner and may have up to eight.

Each burner has three linear resistors, arranged in a parallel configuration over the width of the roasting chamber. The electric equipment of the rotisserie is supplied by three-phase 380 VAC, 50 Hz power set by the companies which produce in accordance with legal regulations and the power conditions. The rotisserie contains a neutral wire and an earthing connection. Power is supplied through a terminal box located at the rear of the appliance. (figure 10)

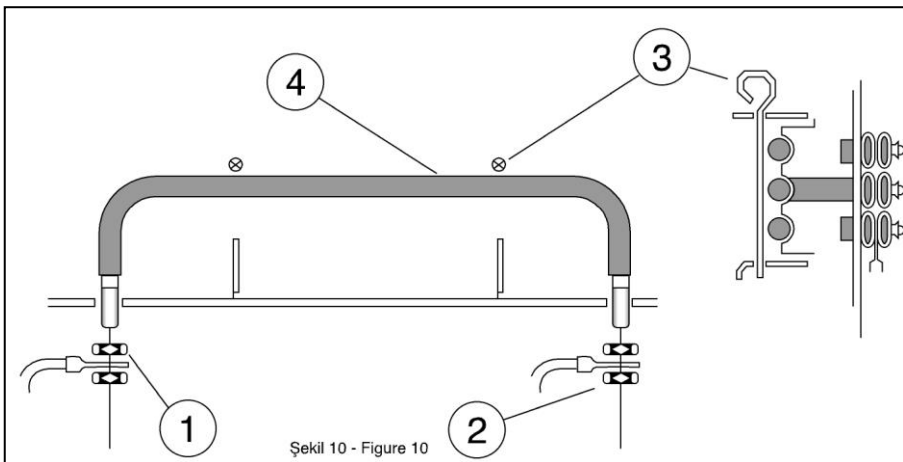

ELECTRICAL CHICKEN ROTISSERIE

MAINS CONNECTION

Remove the control knobs, loosen the screws holding the knob cover and remove the cover. Connect the three phase wires, neutral and earthing connection to the terminal strip, then attach the cable to clamp (A).

Make sure that the cable rating is high enough for the rotisserie power!





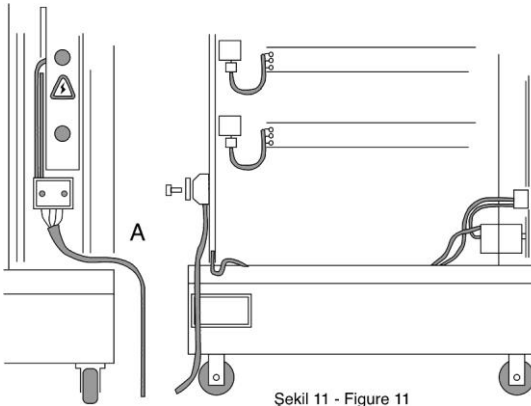



The drive motor is factory-installed and does not require any further installation.

(Figure 11)



Şekil 11 - Figure 11

C SAFETY INSTRUCTIONS

-  *Do not use the appliance in insufficient lighted place.
-  *Do not touch the moving attachments while the appliance operates.
-  *Do not install the appliance in the presence of flammable or explosive materials.
-  *Do not operate the appliance when the machine is empty.
-  *Do not load so less or more than appliance's capacity.
-  *Do not attempt to use the appliance without suitable protective equipments.
-  *Because of any reason if there is a fire or flame flare where the appliance is used, turn off all gas valves and electric contactor switch quickly and use fire extinguisher. Never use water to extinguish the fire.
-  *All the damages because of not having earthing connection will not be on warranty.

D OPERATION

* Control Panel:

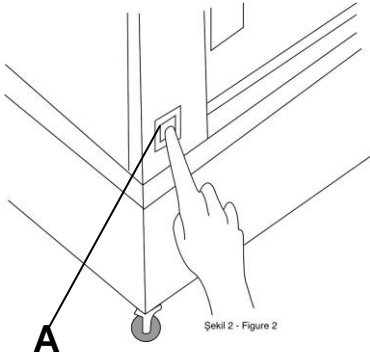

A : ON/OFF button

*Operating:

- Plug in the appliance.
- Switch to (on/off) position.
- The rotisserie is equipped with a drive chain transmission used to rotate all spits at the same time in order to heat all meat evenly. The optimal preset rotational speed for perfect roasting is 4.5 rpm and the gear box ensures maximum continuous torque of 81.9 Ncm (9lbs.inch).
- The transmission is located in the left column (facing the machine), with the motor at the bottom above the base. The column also contains a lighted start-stop switch.
- To use all burners, always begin by lighting the top burner, working downward until reaching the lowest burner as shown. Never leave a burner on for roasting when the only immediately below it is off!
- Your rotisserie comes equipped with an accessory kit that includes spits, skewers, a hook to remove the spits and a tray.
- Used to hold the chickens or pieces of meat. The spits have a square cross-section which is inserted into the drive hubs and used to turn the meat. The spits are equipped with a heat-resistant handle to prevent burns. The number of spits depends on the model.
- Placed beneath the spits at the bottom of the roasting chamber to collect juices released when roasting. Always clean the tray carefully after each roast.
- Turn off all knobs when the rotisserie is not used.

ELECTRICAL CHICKEN ROTISSERIE

E CLEANING & MAINTENANCE

To clean

- To clean the rotisserie, you may use any nontoxic, nonaggressive, product available on the market.
- Take care not to pour the cleaning product directly on the burner's microperforated surface.
- Never use abrasive products that could scratch painted or stainless steel surfaces. The quality of your roasts depend on the cleanliness of your rotisserie.
- To cleaning the plate between the burners

Follow these steps

- a) Push the lower edge of the plate up to its horizontal position.
- b) Push the plate as far as possible.
- c) Pull the plate up and then out to remove completely.

To insert the plate, follow these steps

- a) Insert the horizontal plate such that the side slots match the pivots on both sides.
- b) Let the plate rotate freely.

Tensing the drive chain

To tense the drive chain, loosen the idler pinion screws (A) with a screwdriver and push the pinion slightly to the right until the chain is taut. Tighten the screw (A). Lubricate with molikote-type grease or similar (Figure 9)

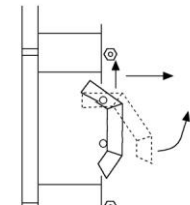

Şekil 8/A - Figure 8/A

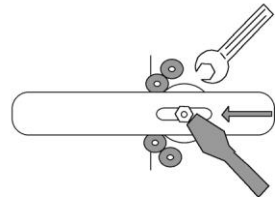
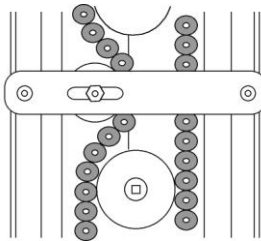

Şekil 9 - Figure 9

ELECTRICAL CHICKEN ROTISSERIE

F TROUBLESHOOTING

THE APPLIANCE DOESN'T OPERATE

1. Check if the appliance is plugged in.
2. Check the electrical connections and voltage.
3. Check if the fuse is on or off.

THE APPLIANCE STOPPED

1. The appliance can stop due to low voltage. In this situation check the voltage.

- If chicken rotisserie is not done at suitable quality
- If any function of security doesn't work,
 - Do not use the appliance.

***If these problems are still going on, contact with our authorized services.**

G APPLIANCE DRAWINGS

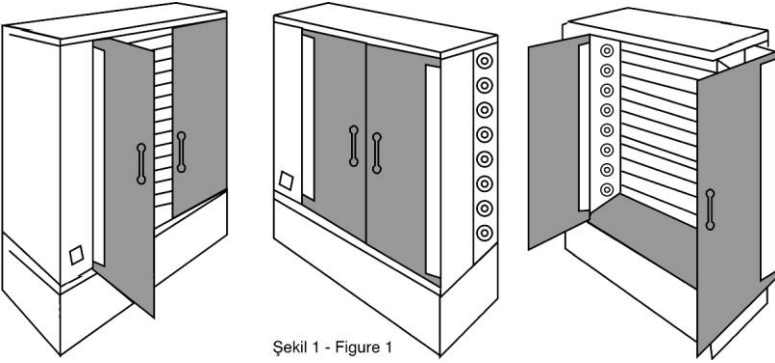

Şekil 1 - Figure 1

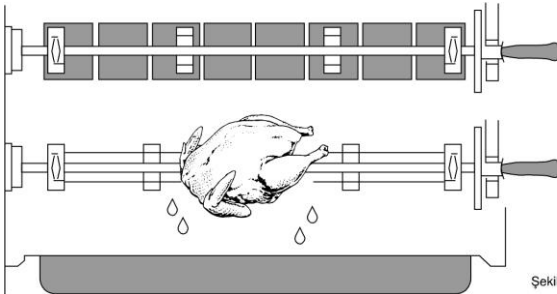

Şekil 4 - Figure 4

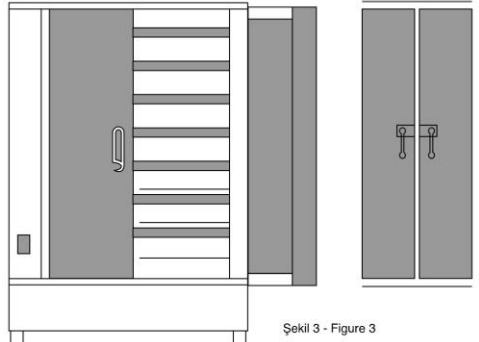

Şekil 3 - Figure 3

ELECTRICAL CHICKEN ROTISSERIE

H SPARE PART LIST- EXPLODING DRAWINGS

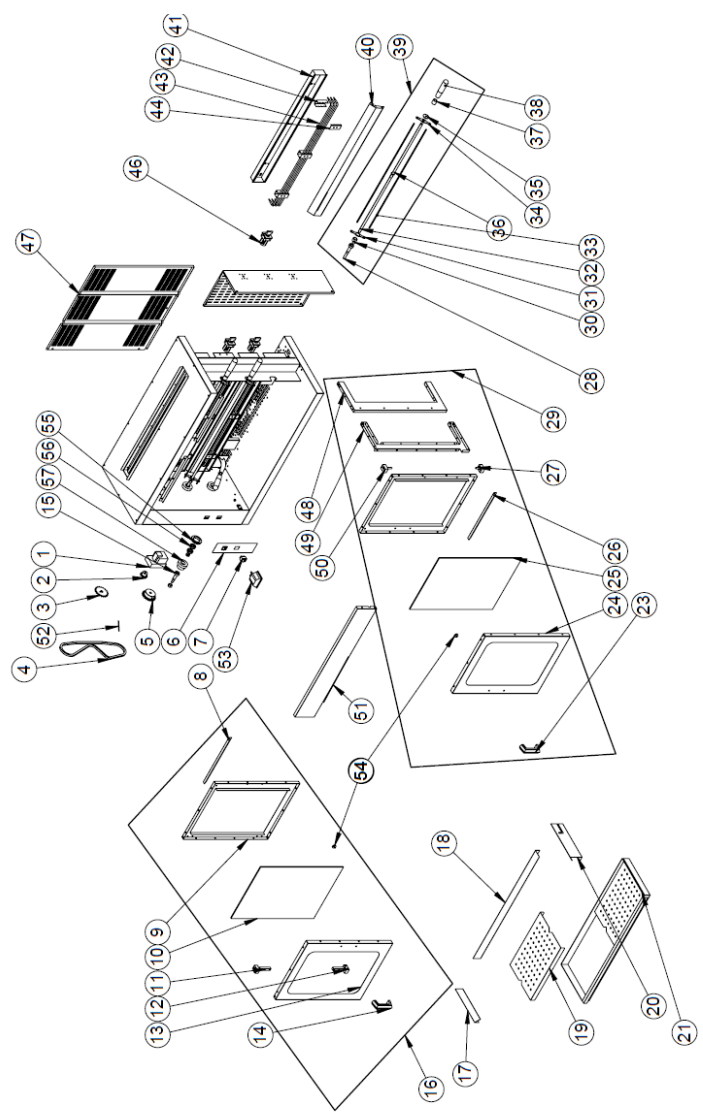

3EE

H YEDEK PARÇ A LİSTESİ-DEMONT E GÖRÜNÜŞ

3EE		
NO	ÜRÜN ADI	ÜRÜN KODU
1	M.ELK-MTR-RMM-002	82662549 CROUZET 230VAC RAP650 ROAST CHICKEN MOTOR
2	M.MON-DSL-003	1-2x1x010 EMP.8EG MOTOR GEAR
3	YSC-KNX.PLC-LZ-0014	8EG 20 TOOTH GEAR
4	GST.M.MUH-081	08 B-1 1 1/2x1 DECKEL CHAIN EMP.3EE-3EG (40 LINES + 1 LOCK) ASSEMBLED
5	M.MON-DSL-004	1-2 1X0.20 EMP.8EG BIG GEAR
6	M.AKS-ETK-LKS-060	EMP.8EG PANEL LABEL
7	ST.M.ELK-SLT-ANL-003	TM1.145 RED CYBER BRAND WIDE ILLUMINATED SWITCH 0-1
8	YSC-KNX.PLC-LZ-0203	EMP.8EG-USA DOOR INTERNAL FRAME CORNER SHEET
9	YSC-KNX.PLC-LZ-0215	EMP.3EG-USA LEFT COVER FRAME INNER SHEET
10	M.CAM-TMP-053	EMP.3EG-USA DOOR GLASS 600X430X6
11	YTL-KNX.PLC-KS-0011	EMP.8EG LEFT GLASS HINGE
12	YTL-KNX.PLC-KS-0016	EMP.8EG TOP HINGE
13	YSC-KNX.PLC-LZ-0214	EMP.3EG-USA LEFT COVER FRAME OUTER SHEET
14	GST.M.AKS-KLP-BKL-010	M6 NO:1 SMALL BAKELITE HANDLE
15	YTL-KNX.PLC-KS-0004	EMP.8EG BEARING SHAFT SHORT
16	ARA-KNX.PLC-0006	EMP.3EG-USA LEFT COVER MNTJ
17	YSC-KNX.PLC-PN-0014	8EG PAN LEFT SIDE PLATE
18	YSC-KNX.PLC-PN-0013	8EG PAN BACK SHEET
19	YSC-KNX.PLC-LZ-0223	EMP.8EG-USA OIL PAN DRAIN PLATE
20	YSC-KNX.PLC-PN-0015	8EG PAN RIGHT SIDE PLATE
21	YSC-KNX.PLC-LZ-0222	8EG-USA OIL PAN SHEET
22	YSC-KNX.PLC-LZ-0224	EMP.8EG-USA STOPPER SHEET
23	GST.M.AKS-KLP-BKL-010	M6 NO:1 SMALL BAKELITE HANDLE
24	YSC-KNX.PLC-LZ-0216	EMP.3EG-USA COVER FRAME OUTER SHEET
25	M.CAM-TMP-053	EMP.3EG-USA DOOR GLASS 600X430X6
26	YSC-KNX.PLC-LZ-0206	EMP.8EG-USA RIGHT COVER INNER FRAME SHEET

ELECTRICAL CHICKEN ROTISSERIE

27	YTL-KNX.PLC-KS-0017	EMP.8EG BOTTOM HINGE
28	YTL-KNX.PLC-KS-0005	EMP.8EG BEARING SHAFT LONG
29	ARA-KNX.PLC-0007	EMP.3EG-USA RIGHT COVER MNTJ.
30	YTL-KNX.PLC-KS-0006	EMP.8EG STURDY BUSHING
31	YSC-KNX.PLC-LZ-0006	8EG SKEWER MOVEMENT SHEET
32	YTL-KNX.PLC-KS-0001	EMP.8EG 12x12 MM SQUARE SHAFT
33	YTL-KNX.PLC-KS-0002	EMP.8EG SKEWER RIGHT LEFT SHAFT DIAMETER 5.8 MM
34	YSC-KNX.PLC-LZ-0005	8EG SKEWER FIXED SHEET
35	YSC-KNX.PLC-LZ-0007	8EG skewer handle spacer
36	YTL-KNX.PLC-KS-0007	EMP.8EG SKEWER HANDLE CONNECTION PART
37	YTL-KNX.PLC-KS-0003	EMP.8EG HANDLE BUSH
38	M.MUH-015	M8 NO.5 BAKALITE OVAL 11CM PEARL HANDLE
39	ARA-GST.PLC-0002	CHICKEN ROAST SHAFT INTERMEDIATE ASSEMBLY
40	YSC-KNX.PLC-LZ-0024	3EE RESISTANCE INTERMEDIATE CLOSING SHEET
41	YSC-KNX.PLC-PN-0047	3EE RESISTANCE SHEET
42	YSC-KNX.PLC-PN-0049	3EE RESISTANCE COMB SHEET BOTTOM
43	M.ELK-RKR-BRU-PLC-001	117749 220V 1000W L:86 cm U FLAT RES. M4 DRY ÖB.5 2 BEND.
44	YSC-KNX.PLC-PN-0048	3EE RESISTANCE COMB SHEET TOP
46	M.ELK-SLT-PKO-002	SIEMENS 3LF0122-4AC00 0-1 3*20A SMALL SWITCH THREE-PHASE
47	YSC-KNX.PLC-PN-0044	3EG REAR COVER SHEET 1
47	YSC-KNX.PLC-LZ-0218	EMP.3EG-USA RIGHT COVER OUTER SHEET
48	YSC-KNX.PLC-LZ-0219	EMP.3EG-USA RIGHT COVER INNER SHEET
49	YTL-KNX.PLC-KS-0015	EMP.8EG RIGHT COVER HINGE SHAFT
50	YSC-KNX.PLC-PN-0045	3EE FRONT LOWER PLATE
51	M.MUH-078	Ø8 B-1 1 1/2x1 DECKEL CHAIN MOTOR EMP. CHICKEN FRIED (25 PODS + 1 LOCK)
52	M.ELK-LMB-AMP-002	G9 25W RECTANGULAR CASED BULB (IMPORTED)
53	M.MIK-GST-005	Ø25x5 MM M5 STUD 300°C RESISTANT MAGNET
54	M.MUH-041-KM-09	AZM MASON NUT EMP.8EG
55	M.RLM-ISI-012	15x35x11 BEARING (6202 ZZ) 280 °C
56	YTL-KNX.PLC-KS-0013	EMP.8EG SHAFT BEARING ALM

ELECTRICAL CHICKEN ROTISSERIE

H YEDEK PARÇA LİSTESİ-DEMONTE GÖRÜNÜŞÜ

5EE

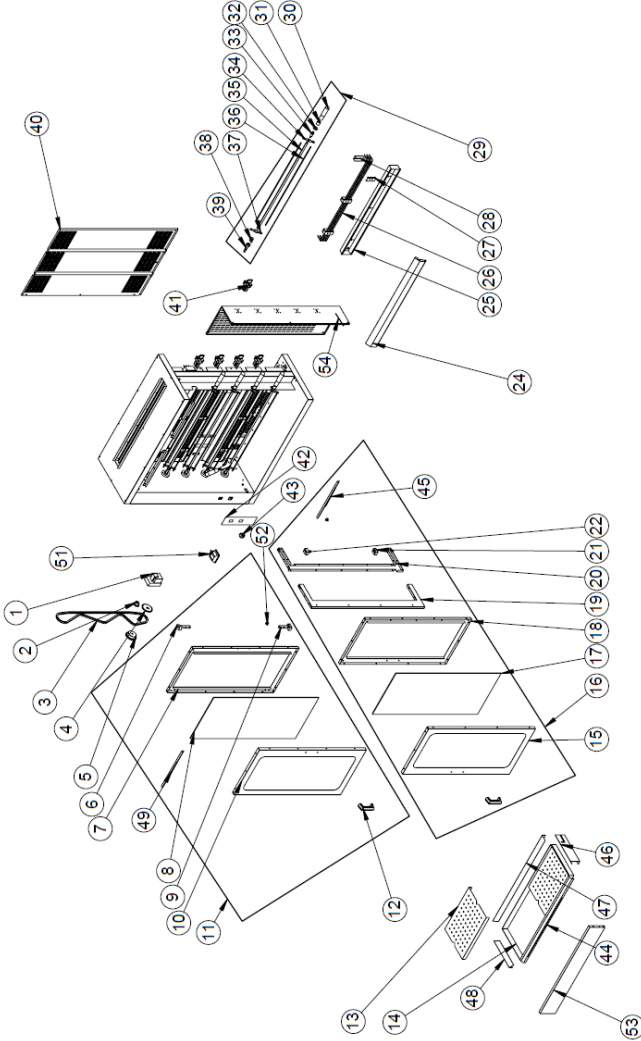

ELECTRICAL CHICKEN ROTISSERIE

H YEDEK PARÇA LİSTESİ-DEMONTE GÖRÜNÜŞÜ

5EE

NO	ÜRÜN ADI	ÜRÜN KODU
1	M.ELK-MTR-RMM-002	82662549 CROUZET 230VAC RAP650 ROAST CHICKEN MOTOR
2	M.MON-DSL-003	1-2x1x010 EMP.8EG MOTOR GEAR
3	M.MUH-079	08 B-1 1 1/2x1 DECKEL CHAIN EMP.5EE-5EG (70 LINES +1 LOCK) COMBINED
4	YSC-KNX.PLC-LZ-0014	8EG 20 TOOTH GEAR
5	M.MON-DSL-004	1-2 1X0.20 EMP.8EG BIG GEAR
6	YTL-KNX.PLC-KS-0011	EMP.8EG LEFT GLASS HINGE
7	YSC-KNX.PLC-LZ-0209	EMP.5EG-USA LEFT COVER FRAME INNER SHEET
8	M.CAM-TMP-052	EMP.5EG-USA DOOR GLASS 960X430X6
9	YTL-KNX.PLC-KS-0017	EMP.8EG BOTTOM HINGE
10	YSC-KNX.PLC-LZ-0208	EMP.5EG-USA LEFT COVER FRAME OUTER SHEET
11	ARA-KNX.PLC-0004	EMP.5EG-USA LEFT COVER MNTJ.
12	GST.M.AKS-KLP-BKL-010	M6 NO:1 SMALL BAKELITE HANDLE
13	YSC-KNX.PLC-PN-0012	8EG OIL PAN STRAIN SHEET
14	YSC-KNX.PLC-PN-0011	8EG OIL PAN SHEET
15	YSC-KNX.PLC-LZ-0211	EMP.5EG-USA COVER FRAME OUTER SHEET
16	ARA-KNX.PLC-0005	EMP.5EG-USA RIGHT COVER MNTJ.
17	M.CAM-TMP-052	EMP.5EG-USA DOOR GLASS 960X430X6
18	YSC-KNX.PLC-LZ-0210	EMP.5EG-USA COVER FRAME INNER SHEET
19	YSC-KNX.PLC-LZ-0212	EMP.5EG-USA RIGHT COVER OUTER SHEET
20	YSC-KNX.PLC-LZ-0213	EMP.5EG-USA RIGHT COVER INNER SHEET
21	YTL-KNX.PLC-KS-0016	EMP.8EG TOP HINGE
22	YTL-KNX.PLC-KS-0015	EMP.8EG RIGHT COVER HINGE SHAFT
23	YSC-KNX.PLC-LZ-0224	EMP.8EG-USA STOPPER SHEET
24	YSC-KNX.PLC-LZ-0024	3EE RESISTANCE INTERMEDIATE CLOSING SHEET
25	YSC-KNX.PLC-PN-0047	3EE RESISTANCE SHEET
26	M.MUH-136-UL	126096 208V 1000W L:86CM U FLAT REZ.M4 DRY
27	YSC-KNX.PLC-PN-0048	3EE RESISTANCE COMB SHEET TOP

ELECTRICAL CHICKEN ROTISSERIE

28	YSC-KNX.PLC-PN-0049	3EE RESISTANCE COMB SHEET BOTTOM
29	ARA-GST.PLC-0002	CHICKEN ROAST SHAFT INTERMEDIATE ASSEMBLY
30	M.ELK-RKR-BRU-PLC-001	117749 220V 1000W L:86 cm U FLAT RES. M4 DRY ÖB.5 2 BEND.
31	YTL-KNX.PLC-KS-0003	EMP.8EG HANDLE BUSH
32	YSC-KNX.PLC-LZ-0007	8EG skewer handle spacer
33	YTL-KNX.PLC-KS-0007	EMP.8EG SKEWER HANDLE CONNECTION PART
34	YSC-KNX.PLC-LZ-0005	8EG SKEWER FIXED SHEET
35	YTL-KNX.PLC-KS-0001	EMP.8EG 12x12 MM SQUARE SHAFT
36	YTL-KNX.PLC-KS-0002	EMP.8EG SKEWER RIGHT LEFT SHAFT DIAMETER 5.8 MM
37	YSC-KNX.PLC-LZ-0006	8EG SKEWER MOVEMENT SHEET
38	YTL-KNX.PLC-KS-0006	EMP.8EG STURDY BUSHING
39	YTL-KNX.PLC-KS-0004	EMP.8EG BEARING SHAFT SHORT
40	YSC-KNX.PLC-PN-0036	5EG REAR COVER SHEET 1
41	M.ELK-SLT-PKO-002	SIEMENS 3LF0122-4AC00 0-1 3*20A SMALL SWITCH THREE-PHASE
42	M.AKS-ETK-LKS-060	EMP.8EG PANEL LABEL
43	GST.M.ELK-SLT-ANL-003	TM1.145 RED CYBER BRAND WIDE ILLUMINATED SWITCH 0-1
44	YSC-KNX.PLC-PN-0045	3EE FRONT LOWER PLATE
45	YSC-KNX.PLC-LZ-0206	EMP.8EG-USA RIGHT COVER INNER FRAME SHEET
46	YSC-KNX.PLC-PN-0015	8EG PAN RIGHT SIDE PLATE
47	YSC-KNX.PLC-PN-0013	8EG PAN BACK SHEET
48	YSC-KNX.PLC-PN-0014	8EG PAN LEFT SIDE PLATE
49	YSC-KNX.PLC-LZ-0203	EMP.8EG-USA DOOR INTERNAL FRAME CORNER SHEET
50	M.MUH-078	08 B-1 1 1/2x1 DECKEL CHAIN MOTOR EMP. FRIED CHICKEN (25 PODS + 1 LOCK)
51	GST.M.ELK-LMB-AMP-002	LH901K G9 25W 230V RECTANGULAR CASED LAMP+BULB (IMPORTED)
52	M.MIK-GST-005	∅25x5 MM M5 STUD 300°C RESISTANT MAGNET
53	YSC-KNX.PLC-PN-0045	3EE FRONT LOWER PLATE
54	YSC-KNX.PLC-PN-0053	5EE PANEL SHEET

ELECTRICAL CHICKEN ROTISSERIE

H YEDEK PARÇA LİSTESİ-DEMONTE GÖRÜNÜŞÜ

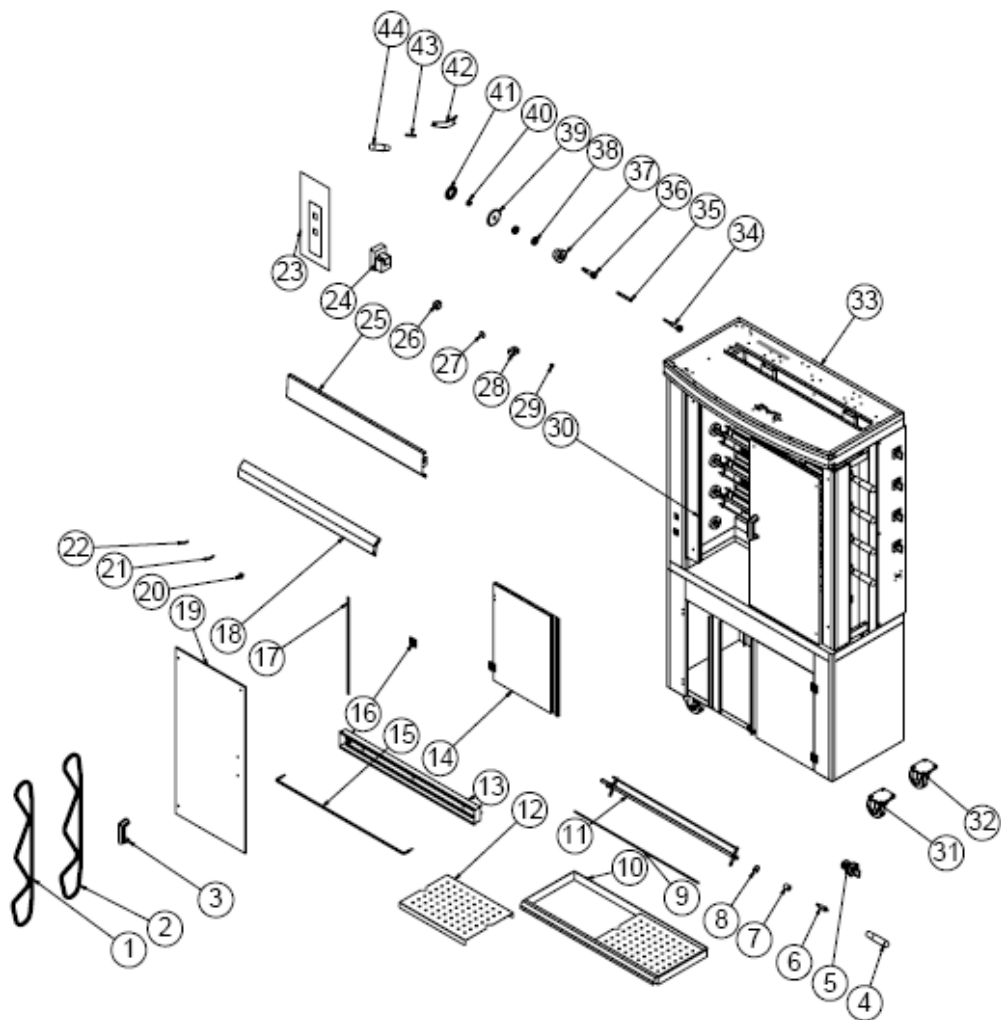

PLS.5EE

H YEDEK PARÇA LİSTESİ-DEMONTE GÖRÜNÜŞÜ

ÜRÜN KODU : EMP.PLS.5EE		
NO	ÜRÜN ADI	Ü. KODU
1	SHORT MOTOR CHAIN	M.MUH-078
2	LONG CHAIN	M.MUH-079
3	BAKELITE HANDLE	GST.M.AKS-KLP-BKL-010
4	OVAL HANDLE	M.MUH-015
5	LEVER	M.ELK-SLT-PKO-002
6	SPACER	YTL-KNX.PLC-KS-0007
7	HANDLE BUSH	YTL-KNX.PLC-KS-0003
8	STAMP	YSC-KNX.PLC-LZ-0007
9	skewer shaft	YCB-TL-YCB-TL-304-5,8-830
10	OIL PAN SHEET	YSC-KNX.PLC-PN-0011
11	TURNING SHAFT	YTL-KNX.PLC-KS-0001
12	SUZEK SHEET	YSC-KNX.PLC-PN-0012
13	RESISTANCE SHEET	YSC-KNX.PLC-PN-0047
14	COVER SHEET	YSC-KNX.PLC-PN-0067
15	U FLAT RESISTANCE	M.ELK-RKR-BRU-PLC-001
16	HINGE	GST.M.AKS-MNT-PLC-001
17	COVER SET SHEET	YSC-KNX.PLC-LZ-0036
18	CLOSING SHEET	YSC-KNX.PLC-LZ-0024
19	TEMPERED GLASS	M.CAM-TMP-042
20	MAGNET	GST.M.MIK-PG-001
21	DOOR LOCK CLIP	GST.M.AKS-KLT-GNL-007
22	DOOR LOCK DEVICE	GST.M.AKS-KLT-GNL-006
23	PANEL GROUP	M.ELK-DMT-PLC-004
24	ENGINE	M.ELK-MTR-RMM-002
25	CLOSING SHEET TOP	YSC-KNX.PLC-LZ-0001
26	KEY 0-1	GST.M.ELK-SLT-ANL-003
27	MICA	M.CAM-MKA-007
28	BOTTOM HINGE	YTL-KNX.PLC-KS-0017
29	COVER BUSH	YTL-KNX.PLC-KS-0010
30	MOTOR GEAR	M.MON-DSL-003
31	WHEEL WITHOUT BRAKE	GST.M.AKS-TKR-PS-005
32	WHEEL WITH BRAKE	GST.M.AKS-TKR-PSF-006
33	CHASSIS	-
34	MILES LONG	YTL-KNX.PLC-KS-0005
35	LIGHTBULB	M.ELK-LMB-ARM-010
36	MILES SHORT	YTL-KNX.PLC-KS-0004
37	SHAFT BEARING	YTL-KNX.PLC-KS-0013
38	6202 ZZ BEARING	M.RLM-ISI-012
39	EXTERNAL GEAR	YSC-KNX.PLC-LZ-0014
40	PIN	GST.B-PIM-SYH-YAR-5*20
41	COIL NUT	M.MUH-045
42	SKEWER HOLDING PLATE	YSC-KNX.PLC-LZ-0025
43	SKEWER HOLDER SHAFT	YTL-KNX.PLC-KS-0018
44	BAKELITE HANDLE	GST.M.AKS-KLP-BKL-010

ELECTRICAL CHICKEN ROTISSERIE

H YEDEK PARÇASI LİSTESİ-DEMONTE GÖRÜNÜŞÜ

8EE

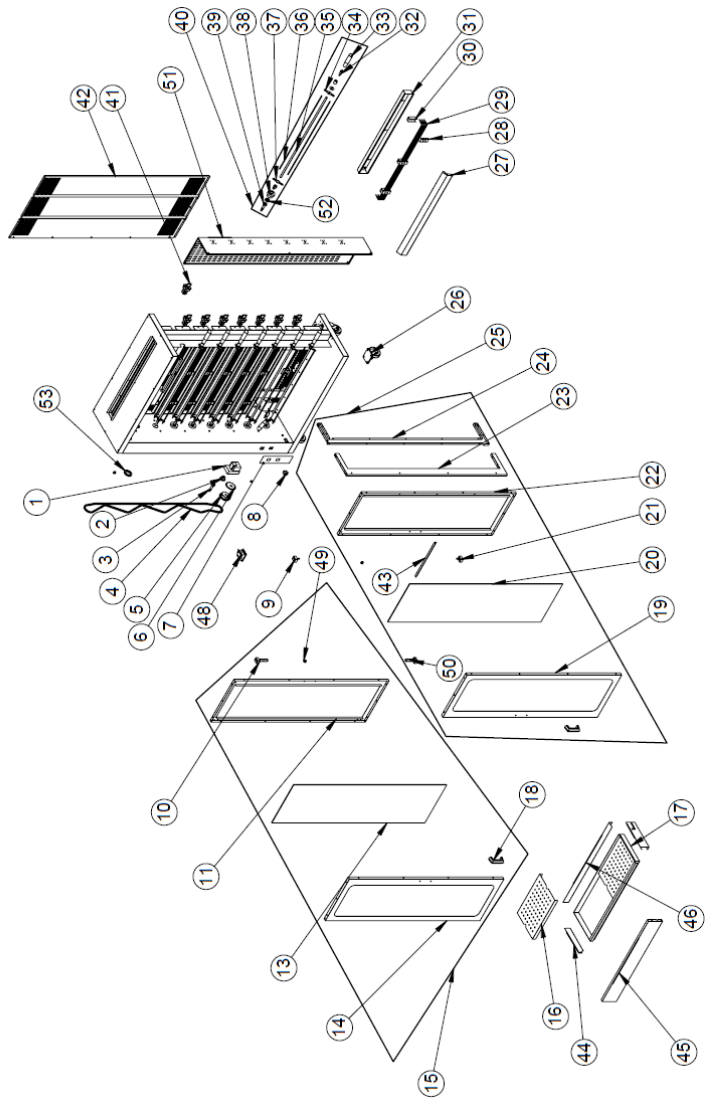

ELECTRICAL CHICKEN ROTISSERIE

H YEDEK PARÇ A LİSTESİ-DEMONTE GÖRÜNÜŞÜ

8EE

NO	ÜRÜN ADI	ÜRÜN KODU
1	M.ELK-MTR-RMM-002	82662549 CROUZET 230VAC RAP650 ROAST CHICKEN MOTOR
2	M.MON-DSL-003	1-2x1x010 EMP.8EG MOTOR GEAR
3	YTL-KNX.PLC-KS-0004	EMP.8EG BEARING SHAFT SHORT
4	M.MUH-078	08 B-1 1 1/2x1 DECKEL CHAIN MOTOR EMP. FRIED CHICKEN (25 PODS + 1 LOCK)
5	M.MON-DSL-004	1-2 1X0.20 EMP.8EG BIG GEAR
6	YSC-KNX.PLC-LZ-0014	8EG 20 TOOTH GEAR
7	M.AKS-ETK-LKS-060	EMP.8EG PANEL LABEL
8	GST.M.ELK-SLT-ANL-003	TM1.145 RED CYBER BRAND WIDE ILLUMINATED SWITCH 0-1
9	YTL-KNX.PLC-KS-0017	EMP.8EG BOTTOM HINGE
10	YTL-KNX.PLC-KS-0011	EMP.8EG LEFT GLASS HINGE
11	YSC-KNX.PLC-LZ-0201	EMP.8EG-USA LEFT COVER FRAME INNER SHEET
12	YSC-KNX.PLC-LZ-0224	EMP.8EG-USA STOPPER SHEET
13	M.CAM-TMP-051	EMP.8EG-USA DOOR GLASS 1500X430
14	YSC-KNX.PLC-LZ-0200	EMP.8EG-USA LEFT COVER FRAME OUTER SHEET
15	ARA-KNX.PLC-0002	EMP.8EG-USA LEFT COVER MNTJ.
16	YSC-KNX.PLC-LZ-0223	EMP.8EG-USA OIL PAN DRAIN PLATE
17	YSC-KNX.PLC-LZ-0222	8EG-USA OIL PAN SHEET
18	GST.M.AKS-KLP-BKL-010	M6 NO:1 SMALL BAKELITE HANDLE
19	YSC-KNX.PLC-LZ-0198	EMP.8EG-USA COVER FRAME OUTER SHEET
20	M.CAM-TMP-051	EMP.8EG-USA DOOR GLASS 1500X430
21	YTL-KNX.PLC-KS-0016	EMP.8EG TOP HINGE
22	YSC-KNX.PLC-LZ-0199	EMP.8EG-USA COVER FRAME INNER SHEET
23	YSC-KNX.PLC-LZ-0196	8EG-USA RIGHT COVER OUTER SHEET
24	YSC-KNX.PLC-LZ-0197	EMP.8EG-USA RIGHT COVER INNER SHEET
25	ARA-KNX.PLC-0003	EMP.8EG-USA RIGHT COVER MNTJ.

ELECTRICAL CHICKEN ROTISSERIE

26	GST.M.AKS-TKR-PSF-006	3802PUB100F18 100*35 RED 180KG CAPACITY WHEEL WITH BRAKE
27	YSC-KNX.PLC-LZ-0024	3EE RESISTANCE INTERMEDIATE CLOSING SHEET
28	YSC-KNX.PLC-PN-0048	3EE RESISTANCE COMB SHEET TOP
29	M.ELK-RKR-BRU-PLC-001	117749 220V 1000W L:86 cm U FLAT RES. M4 DRY ÖB.5 2 BEND.
30	YSC-KNX.PLC-PN-0049	3EE RESISTANCE COMB SHEET BOTTOM
31	YSC-KNX.PLC-PN-0047	3EE RESISTANCE SHEET
32	YTL-KNX.PLC-KS-0007	EMP.8EG SKEWER HANDLE CONNECTION PART
33	M.MUH-015	M8 NO.5 BAKALITE OVAL 11CM PEARL HANDLE
34	YSC-KNX.PLC-LZ-0005	8EG SKEWER FIXED SHEET
35	YTL-KNX.PLC-KS-0001	EMP.8EG 12x12 MM SQUARE SHAFT
36	YTL-KNX.PLC-KS-0002	EMP.8EG SKEWER RIGHT LEFT SHAFT DIAMETER 5.8 MM
37	YSC-KNX.PLC-LZ-0006	8EG SKEWER MOVEMENT SHEET
38	YTL-KNX.PLC-KS-0013	EMP.8EG SHAFT BEARING ALM
39	YTL-KNX.PLC-KS-0004	EMP.8EG BEARING SHAFT SHORT
40	ARA-GST.PLC-0002	CHICKEN ROAST SHAFT INTERMEDIATE ASSEMBLY
41	M.ELK-SLT-PKO-002	SIEMENS 3LF0122-4AC00 0-1 3*20A SMALL SWITCH THREE-PHASE
42	YSC-KNX.PLC-PN-0026	8EG REAR COVER SHEET 1
43	YSC-KNX.PLC-LZ-0206	EMP.8EG-USA RIGHT COVER INNER FRAME SHEET
44	YSC-KNX.PLC-PN-0014	8EG PAN LEFT SIDE PLATE
45	YSC-KNX.PLC-PN-0045	3EE FRONT LOWER PLATE
46	YSC-KNX.PLC-PN-0013	8EG PAN BACK SHEET
47	M.MUH-080	08 B-1 1 1/2x1 DECKEL CHAIN EMP.8EE-8EG (114 LINKS + 1 LOCK) COMBINED
48	GST.M.ELK-LMB-AMP-002	LH901K G9 25W 230V RECTANGULAR CASED LAMP+BULB (IMPORTED)
49	M.MIK-GST-005	∅25x5 MM M5 STUD 300°C RESISTANT MAGNET
50	YTL-KNX.PLC-KS-0011	EMP.8EG LEFT GLASS HINGE
51	YSC-KNX.PLC-PN-0051	8EE PANEL SHEET
52	M.RLM-ISI-012	6202 ZZ BEARING (35*15*11)
53	M.MUH-041-KM-09	AZM MASON NUT EMP.8EG

I ELECTRIC CIRCUIT SCHEMA

